



INDUSTRIAL

For Sale/Lease



905 Industrial Road, Marshall, Michigan

Sale Price:	\$1,300,000 (Cost per Sq. Ft. \$9.85)
Lease Rate:	\$2.00 - \$2.40
Total Building Sq. Ft.:	132,000
Total Office Sq. Ft.:	4,000
Total Shop Sq. Ft.:	128,000
Acreage:	42
Zoning:	I-2
Ceiling Height::	18'3"
Truck Docks:	9, Exterior
Overhead Doors:	One
Column Spacing:	Varied
HVAC Systems:	Gas / Forced Air ,Space Heaters
Power:	480 V / 1500 KVA / 3 Phase
Sewer / Water:	Public / Public
Year Built:	1970 / 1985
Taxes:	\$22,148 (2009)
Taxable Value:	\$340,761 (2009)
SEV:	\$364,100 (2009)



Comments: Marshall industrial building for sale or lease - 9 docks, 1 grade level door, 18' ceiling height, 40x40 columns, 1200 KVA 480 Volt 3 Phase power, sprinklers inside, flexible space or take it all.

For Additional Information:

Mac Behnke
(269) 962-0034
Mbehnke@behnkelogistics.com

Information is subject to verification and no liability for errors or omissions is assumed. Price and terms are subject to modification.



INDUSTRIAL

For Sale/Lease

905 Industrial Road, Marshall, Michigan

Floor Plan

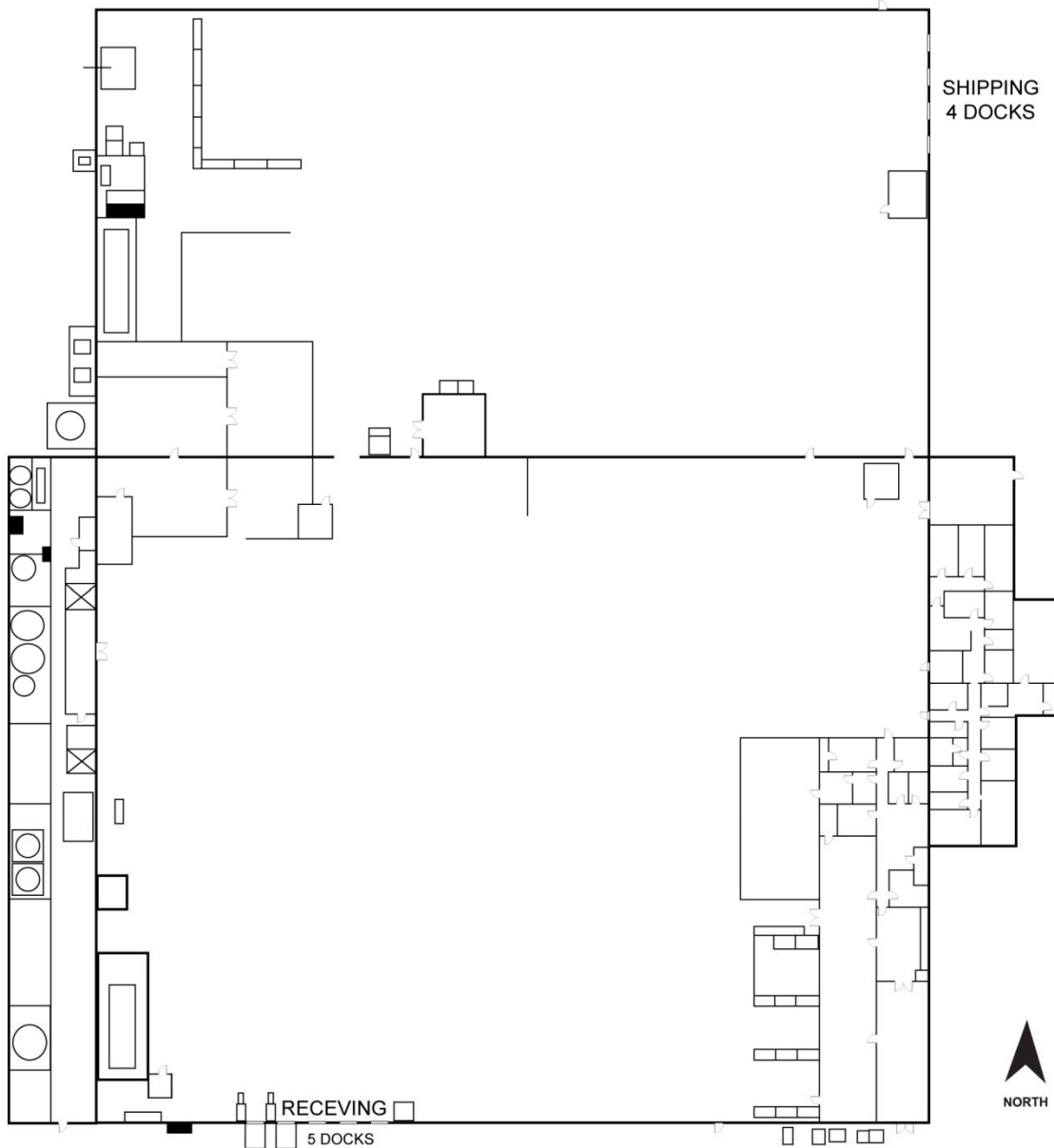

NOT DRAWN TO SCALE



INDUSTRIAL

For Sale/Lease

905 Industrial Road, Marshall, Michigan

Site Plan

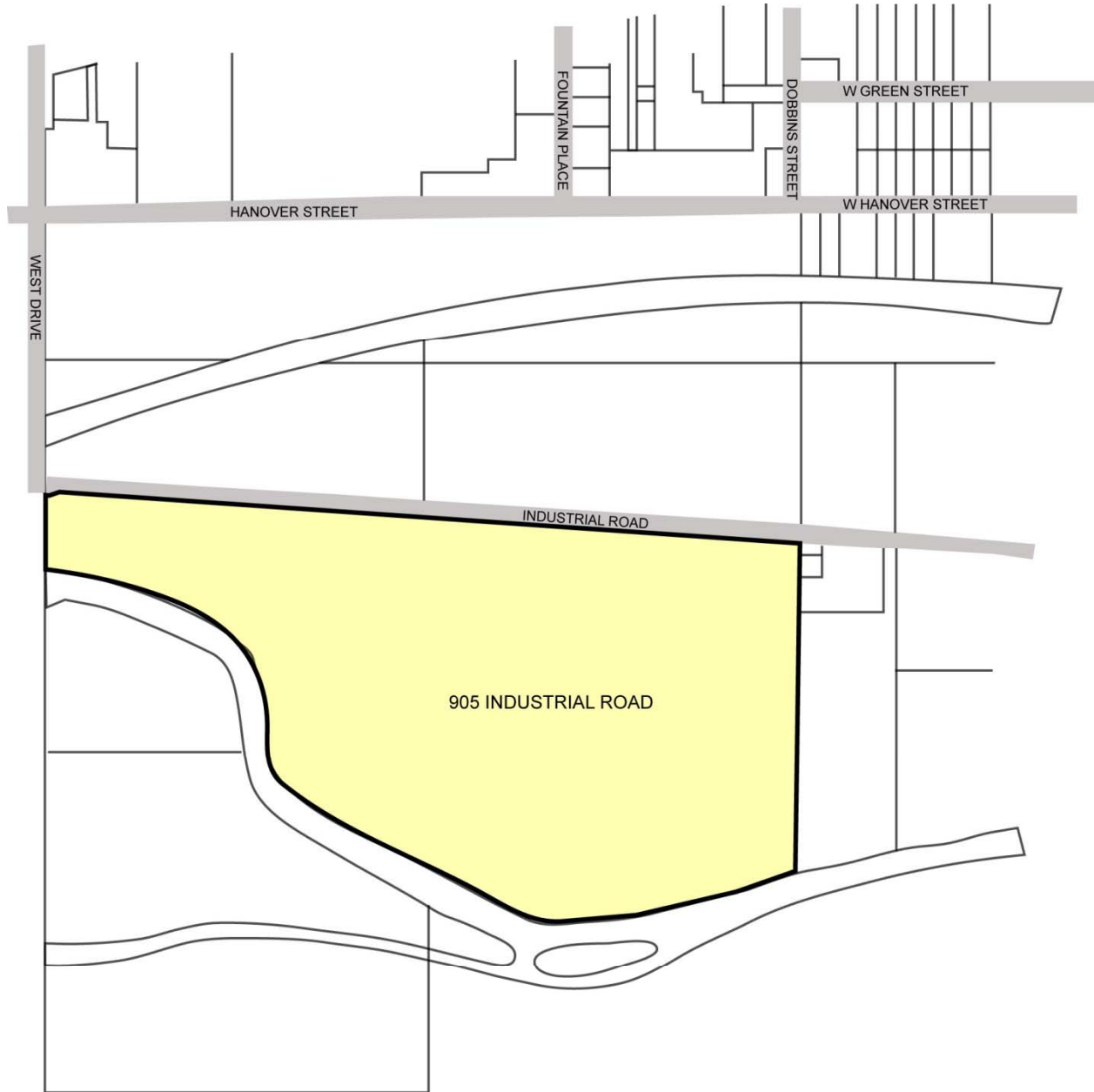



INDUSTRIAL

For Sale/Lease

905 Industrial Road, Marshall, Michigan

Photos



Information is subject to verification and no liability for errors or omissions is assumed. Price and terms are subject to modification.



INDUSTRIAL

For Sale/Lease

905 Industrial Road, Marshall, Michigan

Aerial

